

## Thin Sheet Half Hex Blind Nut **PMHSCZ**

<b>Body Type / Flange Type</b>	<b>Open End &amp; Half Hex Body / Small Flange</b>
<b>Material</b>	<b>Carbon Steel</b>
<b>Finish</b>	<b>Zinc plated</b>

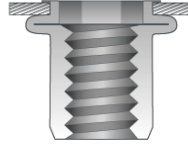
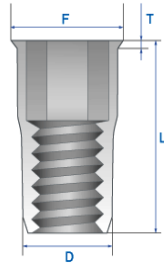

**F = Flange Diameter**  
**T = Flange Thickness**  
**L = Body Length**  
**D = Body Diameter**

\*Dimensions in millimeters

Part Number	Thread Size	D max.	Hole Size (+0.1)	L (±0.4)	Grip Range	F (±0.25)	T (±0.15)
PMHSCZ-040020	M4 X 0.7	5.90	6.0	10.8	0.5~2.0	8.0	0.6
PMHSCZ-050025	M5 X 0.8	6.90	7.0	13.0	0.5~2.5	9.1	0.7
PMHSCZ-060030	M6 X 1.0	8.95	9.0	15.5	0.5~3.0	11.5	0.8
PMHSCZ-080030	M8 X 1.25	10.96	11.0	18.5	0.5~3.0	14.1	1.0
PMHSCZ-100030	M10 X 1.5	12.95	13.0	21.0	1.0~3.0	16.4	1.2

## Large Flange Half Hex Blind Nut **PMHLCZ**

<b>Body Type / Flange Type</b>	<b>Open End &amp; Half Hex Body / Large Flange</b>
<b>Material</b>	<b>Carbon Steel</b>
<b>Finish</b>	<b>Zinc plated</b>

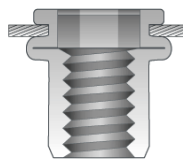
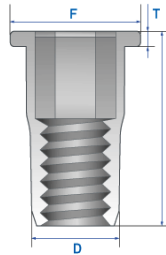

**F = Flange Diameter**  
**T = Flange Thickness**  
**L = Body Length**  
**D = Body Diameter**

\*Dimensions in millimeters

Part Number	Thread Size	D max.	Hole Size (+0.1)	L (±0.4)	Grip Range	F (±0.25)	T (±0.15)
PMHLCZ-040020	M4 X 0.7	5.90	6.0	10.8	0.5~2.0	8.9	0.80
PMHLCZ-050025	M5 X 0.8	6.90	7.0	13.0	0.5~2.5	10.0	0.85
PMHLCZ-060030	M6 X 1.0	8.95	9.0	15.5	0.5~3.0	13.0	1.40
PMHLCZ-080030	M8 X 1.25	10.96	11.0	18.5	0.5~3.0	16.0	1.60
PMHLCZ-100030	M10 X 1.5	12.95	13.0	21.0	1.0~3.0	18.0	1.70